



Product guide

A737, A738 Wall pegs, A747, A748 Peg rail

IMPORTANT

Save these instructions for reference

Recommended use

These wall-mounted units are designed for situations where a full-size freestanding unit would be impractical because of limited floor space or budget. The name holders provide an easy way to personalise the space for each child.

Products consist of the following:

A737 Wall pegs with labels 6 – including:
Three clear plastic name covers.

A747 Peg rail 6

A738 Wall pegs with labels 8 – including:
Four clear plastic name covers.

A748 Peg rail 8

A721 Four extra name covers

If your shipment is incomplete, please contact customer service.

⚠ WARNING

▲ This product is intended for use by children of immature judgment, therefore supervision is required at all times. Never install these units with children nearby.

⚠ CAUTION

▲ For indoor use only. This product is not weather proof.

Maintenance

Periodically inspect for cracks, breaks, and loose or missing parts. Check that the unit remains securely mounted to the wall. Remove the product from service if any condition develops that might make operation unsafe.

Cleaning

Wipe with a damp cloth and mild detergent. Dry immediately. Leaving water or cleaning agent on the surface may damage the finish.

Construction

The wooden components are manufactured from solid hardwoods and birch plywood protected with a child-safe finish. The hooks and name covers are plastic.

Installation

A competent carpenter or maintenance person should do the installation.

Wall pegs with labels and Peg rail

1. Position Wall pegs or Peg rail at the desired place on the wall.
2. Locate the fasteners (not included) to suit the wall construction, with at least one fastener near each end of the unit as shown in Figure B.

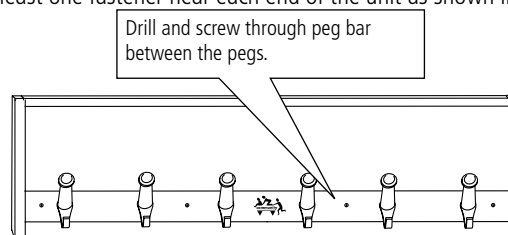

Figure A

3. Pre-drill the piece of wood with the pegs in at these locations.
4. Attach the Wall pegs or Peg rail to the wall with fasteners appropriate to the wall construction and the weight of the fully loaded unit.

⚠ WARNING

▲ Wall pegs must be properly mounted before use. It is the customer's responsibility that it will be secure.

Operation

Removal of name covers

To remove the name cover push it up into the top slot and pull the bottom edge forward.

To install a name cover push it up into the top slot and push the bottom edge in, and then slide the name cover down into the bottom slot. See Figure B.

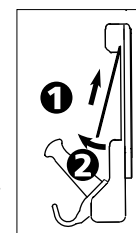

Figure B

User modifications

We cannot be responsible for modifications made by customers to our products in the field without our supervision, testing, or evaluation.

Ordering parts

To order replacement parts, contact customer service with a description of the part(s) needed and the ID code from the product.

Use only replacement parts supplied by Community Playthings.

All of our packaging is recyclable (cardboard and LDPE). Please recycle in accordance with local guidelines.